

# Nano circular connectors



# **Nano circular connectors**

**December, 2024**



# Table of contents

- Introduction . . . . . 6
- Glossary of terms . . . . . 8
  - Pigtail description . . . . . 8
  - PCB connectors description . . . . . 9
- General characteristics . . . . . 10
- Wire code . . . . . 11
  - Uninsulated wires . . . . . 11
  - Insulated wires . . . . . 11
- Colour code . . . . . 12
  - Colour codes F and L . . . . . 12
  - Colour code W . . . . . 12
- Contact arrangements . . . . . 13
- Panel mounting . . . . . 14
  - Front panel mouting (only for pigtail) . . . . . 14
  - Rear panel mounting (pigtail or PCB) . . . . . 15
  - Required space for mounting . . . . . 16
- Nano Circular PCB connectors . . . . . 17
  - Recommended screws for PCB mounting . . . . . 17
  - Panel mount for PCB-CBR mounting . . . . . 17
- Swappable inserts . . . . . 18
- REACH & RoHS compliance . . . . . 19
  - RoHS compliance . . . . . 19
  - Application of REACH . . . . . 19

**NANO CIRCULAR PLASTIC PIGTAIL**

- Identification code . . . . . 20

**NANO CIRCULAR PIGTAIL CONNECTORS**

- Identification code . . . . . 21
- Pigtail In-Line (IL) . . . . . 22
- Pigtail In-Line with backshell (IB) . . . . . 23
- Pigtail Front Mount Oval Flange (OF) . . . . . 24
- Pigtail Jam Nut Rear Mount with backshell (JB) . . . . . 25
- Pigtail Jam Nut Rear Mount (JR) . . . . . 26

**NANO CIRCULAR PCB PIGTAIL CONNECTORS**

- Identification code . . . . . 27
- PCB CBR In-Line (IL) . . . . . 28
- PCB CBR Jam Nut Rear Mount (JR) . . . . . 29
- PCB BS In-Line (IL) . . . . . 30
- PCB BS Jam Nut Rear Mount (JR) . . . . . 31
- CBR layout . . . . . 32
- BS Layout . . . . . 33



▲ ENGINEERING DEPARTMENT

# Nano circular connectors

## ABOUT AXON'

Headquartered in the beautiful Champagne region of France, AXON' is a worldwide leader in specialist interconnect. The company excels in the design and manufacture of wires, cables, terminated harnesses and interconnect solutions for high technology applications.

As a specialist in advanced interconnect solutions, Axon' Cable has extensive experience in **Micro-D connectors** including pigtail and PCB connectors, solder cup connectors, QPL qualified Micro-D to MIL-DTL-83513, micro-strip and saver connectors.

## AXON'S EXPERTISE

AXON' is renowned for its expertise in a number of areas, for example :

- In **metallurgy** through the manufacture of specialist conductors (fine wire drawing, multi stranded conductors and silver plating of both copper and aluminium).
- In **plastics technology**, the company is a specialist in the extrusion of fluoropolymers such as TEFLON®, PTFE, FEP and PFA in accordance with the KZ or M22759/11 standards for TEFLON® wires and KU or M22759/33 for TEFZEL® wires.
- In the design and manufacture of **complex harnesses**, incorporating a wide range of interconnect technologies, and always the AXON' built-in signature of high quality and reliability.

AXON' works closely with universities, research centres and other educational establishments, investing some 10% of yearly turnover into Research and Development.

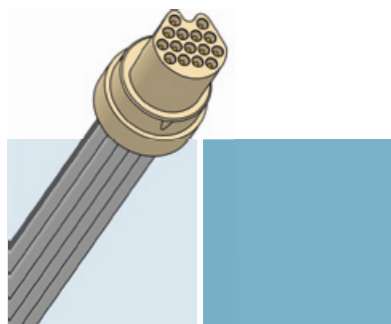

AXON' is an acknowledged expert in the field of EMI protection for interconnect systems, and has particular expertise in carrying out transfer impedance (ZI) measurements on cables, connectors and complete harnesses. The French DGA (equivalent to US Department of Defence or UK Ministry of Defence) has commissioned a number of studies by AXON', in particular on shield termination techniques and the efficiency of wiring harness shields.

## AXON' NANO-D CONNECTORS

In addition to the standard range of Micro-D connectors and assemblies, AXON' is able to offer the even smaller rectangular and circular **Nano connectors** and assemblies based on highly reliable Twist Pin contact technology. They meet all the requirements of **MIL-DTL-32139**. Such solutions are ideal for applications including aerospace, military, industrial, medical or offshore which require extreme miniaturization, space or weight saving and reliability.

AXON's range of **Nano circular connectors** delivers substantial weight and space gains on electronic systems. Waterproof designs are also available if required with protection levels to IP67 or IP68.

## DIFFERENT CONFIGURATIONS

- Nano circular connectors for wires (pigtail assemblies).
- Nano circular connectors for PCBs.
- Nano circular connectors built directly into harnesses.

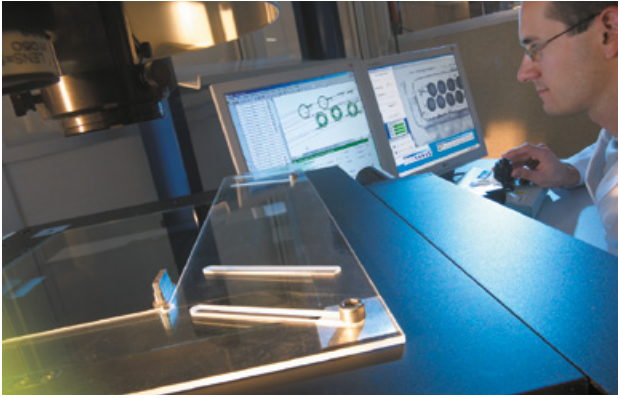

▲ METROLOGY LABORATORY



▲ CLEAN ROOM

# Axon' solutions

## CHARACTERISTICS

- 0.635mm spacing (pitch) between contacts in each row.
- 0.635mm spacing between rows.
- Number of ways: 15, 25 and 37.
- High reliability **Twist Pin contacts**.
- Metal shell with captive hardware.
- Plastic pigtail solution without shells and hardware (size of the connector roughly equal to the diameter of the bundle).
- Threaded Solution available.

## CUSTOM DESIGNED CONNECTORS & ASSEMBLIES: YOUR SPECIAL IS OUR STANDARD

To meet the most severe requirements, AXON' has been able to offer customised solutions including:

- High current transmission.
- Optimised, space saving wiring solutions.
- Solutions to optimise the process for mass manufacture.
- EMC optimised designs.
- Solutions to facilitate mechanical integration:
- Special hardware, miniaturisation, super flexible wires and cables.
- Custom shell designs to suit specific requirements.
- Custom materials and finishes.



QUALITY  
ASSURANCE

ISO 9001

EN 9100

ISO 14001

ISO 45001

# GLOSSARY OF TERMS

## ► Pigtail description

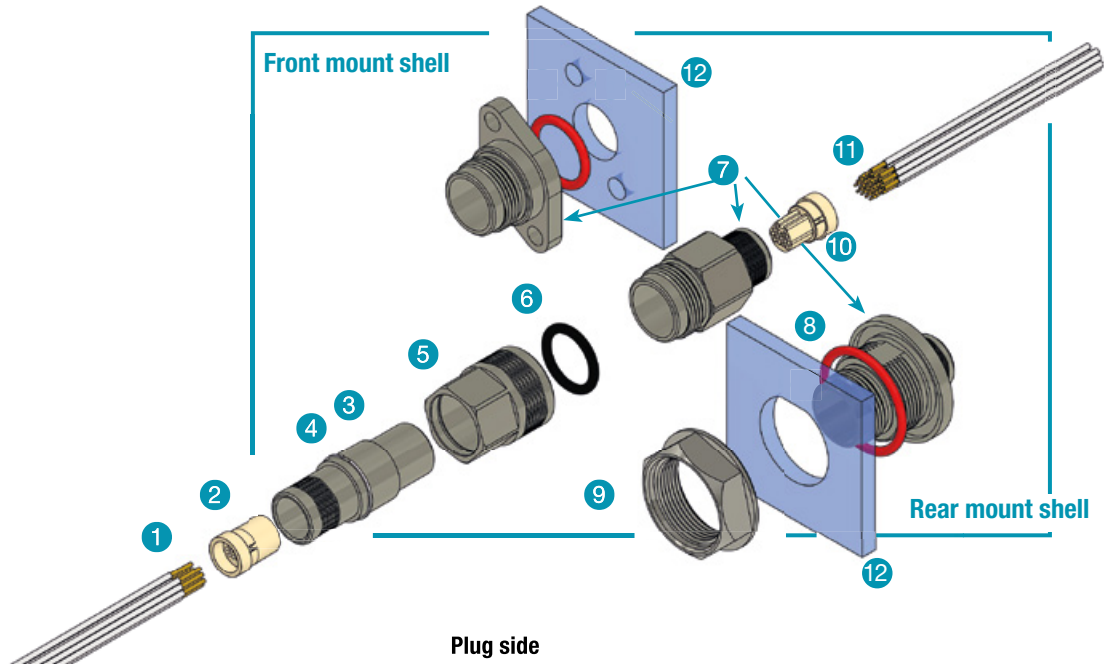

### Plug side

- 1 Wired socket contacts
- 2 Female insert
- 3 Plug shell
- 4 Circlip
- 5 Coupling Ring
- 6 O-ring (optional for IP67 when mated)

### Receptacle side

- 7 Receptacle shell (3 options)
- 8 O-ring for panel mouting (panel mount versions only)
- 9 Jam nut (required only for for rear panel mounting)
- 10 Male insert
- 11 Wired Twist Pin contacts
- 12 Panel cut-out

- Standard connector ● Manufactured to the standard dimensions and specifications.
- Special connector ● A standard connector modified to meet specific customer requirements.
- Pigtail connector ● Connector with insulated or uninsulated wires.
- PCB connector ● Connector suitable for termination to a Printed Circuit Board.
- CBR connector ● Condensed Board Right angle connector.
- BS connector ● Board Straight connector.

## ► PCB connectors description

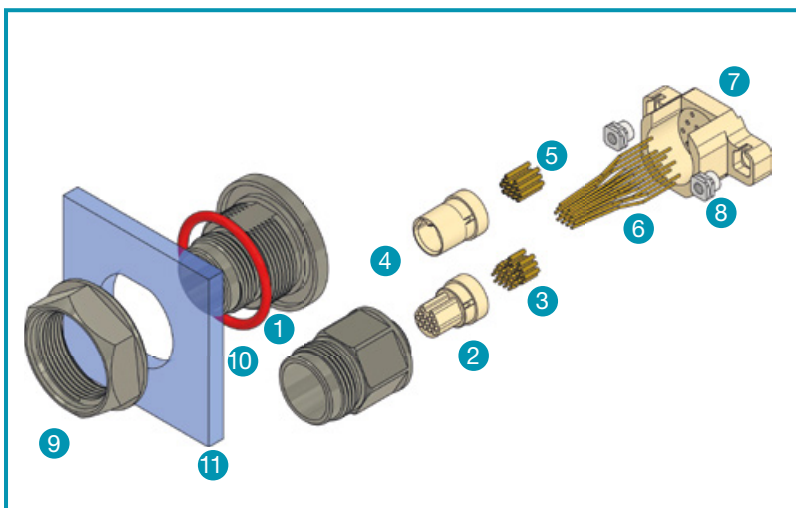
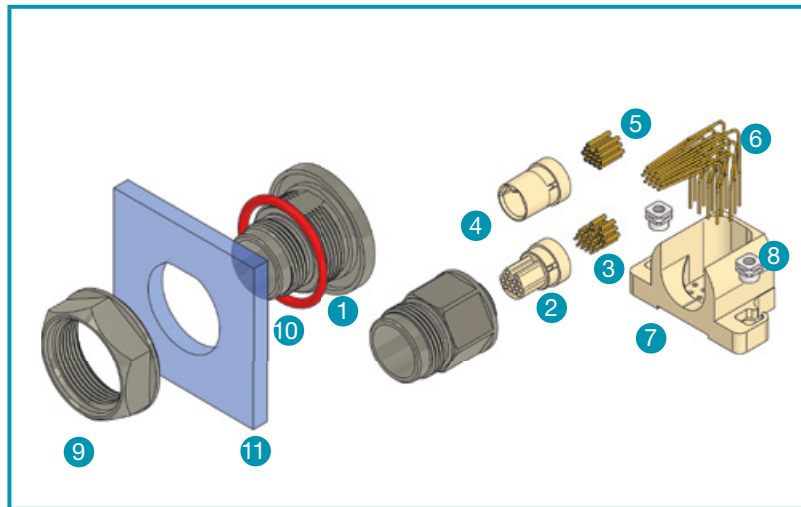

- 1 Receptacle shell
- 2 Male insert
- 3 Pin contacts
- 4 Female insert
- 5 Socket contacts
- 6 Uninsulated solid wires
- 7 Tray
- 8 Hardware for PCB mounting
- 9 Jam nut
- 10 O-ring for panel mounting
- 11 Panel cut-out

# GENERAL CHARACTERISTICS

AXON's range of Nano-D connectors which is covered by the MIL-DTL-32139\* standard, is ideally suited to equipment and applications where weight, miniaturization and long-term performance are required. The Nano Circular range is available in 3 contact arrangements, 15, 25 and 37 contacts.

## ELECTRICAL & MECHANICAL CHARACTERISTICS

CHARACTERISTICS	SPECIFICATION	TEST METHOD
CURRENT RATING	1 A max.	EIA-364-70
CONTACT RESISTANCE	71 mΩ max.	EIA-364-06
INSULATION RESISTANCE	5000 MΩ min. @ 100 V <sub>ac</sub>	EIA-364-21
DIELECTRIC WITHSTAND VOLTAGE - SEA LEVEL : 0 M ALTITUDE 21 KM (70 000FT)	250 V <sub>ac</sub> 100 V <sub>ac</sub>	EIA-364-20
CONTACT ENGAGING AND SEPARATION FORCE	141 g max. (5oz) 11 g min. (0.4oz)	EIA-364-37
CONNECTOR MATING AND DE-MATING FORCE	198 g (7oz) x number of contacts max.	EIA-364-13
CONTACT RETENTION	0.9 kg (2lbs) for 5 seconds min.	EIA-364-29
DURABILITY	200 mating cycles min.	EIA-364-09
TEMPERATURE RANGES STANDARD	-55°C/+150°C	
VIBRATION	20 g – no discontinuity >1 μs	EIA-364-28 - TEST CONDITION IV
SHOCK	100 g's – no discontinuity >1 μs	EIA-364-27 - TEST CONDITION E
SALT SPRAY	48 hours	EIA-364-26 - TEST CONDITION B
HUMIDITY	Insulation resistance > 1 MΩ	EIA-364-31 - TEST METHOD IV - Test condition B (excluding steps 7A & 7B)**

\*: issue B amendment 1 at the time of going to press. - \*\*: according to MIL-DTL-32139.

## MATERIAL & FINISH

COMPONENT	MATERIAL	FINISH
MALE CONTACT (TWIST PIN)	Gold alloy in accordance with ASTM-B-477 OR 541 OR 562	None
FEMALE CONTACT	Gold alloy in accordance with ASTM-B-477 OR 541 OR 562	None
METAL SHELL	Aluminium alloy, type 7075	Electroless nickel plating in accordance with SAE-AMS-2404, Class 4
INSERT/PCB TRAY	PEEK or LCP	
HARDWARE	Stainless steel, 300 series	Passivation in according with SAE-AMS-2700
ENCAPSULANT	Epoxy resin	
INSULATED WIRE	PTFE insulated silver plated copper in accordance with NEMA-HP3	
UNINSULATED WIRE	Gold plated solid copper wire in accordance with A-A-56551 or gold plated solid copper based alloy in accordance with ASTM-B-194 (Code G)	Gold plating in accordance with ASTM-B488, type II, class 1 (1.27μm min. (0.00005")), code C over nickel underplate in accordance with SAE-AMS-QQ-N-290, class 2 (1,27μm)
	Gold plated solid copper wire in accordance with A-A-56551 or gold plated solid copper based alloy in accordance with ASTM-B-194 (Code D)	Gold flash plating in accordance with ASTM-B488, type II, code C over nickel underplate in accordance with SAE-AMS-QQ-N-290, class 2 (1,27μm)

# WIRE CODE

Nominal dimensions are used throughout this chapter.

## ► Uninsulated wires

WIRE CODE	WEIGHT g/m	CONDUCTOR					
		MATERIAL	AWG	CONSTRUCTION mm (inch)	Ø mm (inch)	AREA mm <sup>2</sup> (sq in)	RESISTANCE Ω/100m (Ω/1000 ft)
G	0.45	GOLD PLATED COPPER	30	1x0.254 (1x.010)	0.254 (.010)	0.051 (.00008)	190 (579.1)
D	0.45	GOLD FLASH PLATED COPPER	30	1x0.254 (1x.010)	0.254 (.010)	0.051 (.00008)	190 (579.1)

## ► Insulated wires

WIRE CODE	WIRE DESIGNATION	WEIGHT g/m	CONDUCTOR						INSULATION		TEMPERATURE RATING	VOLTAGE RATING
			MATERIAL	AWG	CONSTRUCTION mm (inch)	Ø mm (inch)	AREA mm <sup>2</sup> (sq in)	RESISTANCE Ω/100m (Ω/1000 ft)	MATERIAL	Ø mm (inch)		
1	ET 3007	1.50	SPC *	30	7x0.102 (7x.0040)	0.304 (.012)	0.057 (.000882)	31 (94.0)	EXTRUDED PTFE	0.62 (.024)	-90°C / +200°C	250 V <sub>AC</sub>
2	ET 3207	1.20	SPC *	32	7x0.079 (7x.0031)	0.237 (.009)	0.034 (.00005)	52 (158.5)	EXTRUDED PTFE	0.57 (.022)	-90°C / +200°C	250 V <sub>AC</sub>
3	ET 3407	1.00	SPC *	34	7x0.063 (7x.0025)	0.189 (.007)	0.022 (.00003)	95 (289.6)	EXTRUDED PTFE	0.50 (.020)	-90°C / +200°C	250 V <sub>AC</sub>
4	ET 3607	0.80	SPC *	36	7x0.050 (7x.0020)	0.150 (.006)	0.014 (.00006)	150 (457)	EXTRUDED PTFE	0.48 (.035)	-90°C / +200°C	250 V <sub>AC</sub>

\*: Silver plated copper.

# COLOUR CODE

## ► Colour codes F and L

All the wires have the same colour.  
Available with all wire types.

COLOUR CODE	COLOUR
F	YELLOW
L	WHITE

## ► Colour code W

Also called 10 colour repeat (10 colours repeated in sequence) as per MIL-DTL-83513. Available with all wire types.

PIN NUMBER	MIL-STD-681 NUMBER	COLOUR
1	0	BLACK
2	1	BROWN
3	2	RED
4	3	ORANGE
5	4	YELLOW
6	5	GREEN
7	6	BLUE
8	7	VIOLET
9	8	GREY
10	9	WHITE
11	0	BLACK
12	1	BROWN
13	2	RED
14	3	ORANGE
15	4	YELLOW
16	5	GREEN
17	6	BLUE
18	7	VIOLET
19	8	GREY
20	9	WHITE
21	0	BLACK

# CONTACT ARRANGEMENTS

**MATING FACE  
OF MALE INSERT**

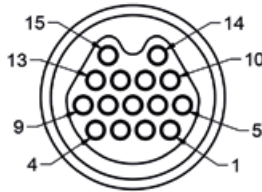

**15 CONTACTS**

**MATING FACE  
OF FEMALE INSERT**

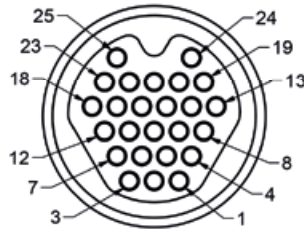
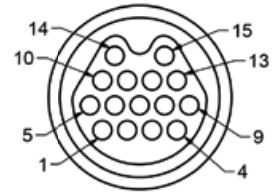

**25 CONTACTS**

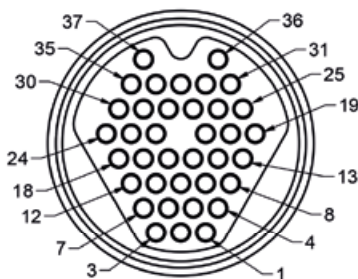
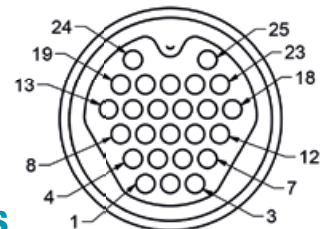

**37 CONTACTS**

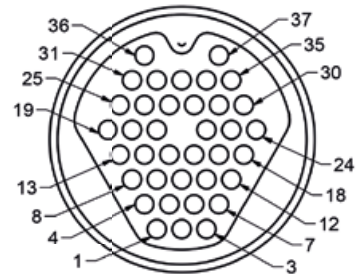

- 0.635mm (.025") contact spacing.
- 0.635mm (.025") spacing between rows.

Both inserts can be mounted in either plug or receptacle shell to help avoid any mis-mating on customer equipment.

# PANEL MOUNTING

AXON's circular Nanos come with two methods for panel mounting:

- Front mount with oval flange (for wired pigtail connectors only);
- Rear mount with circular flange, for both pigtail and PCB connectors.

Both are shown below with their respective panel cut-outs. Solutions: front mount with Oval flange (only for pigtail) and round shape rear mount (for pigtails and PCB connectors). Those are described with their own panel cutout below.

## ► Front panel mounting (for pigtail versions only)

### ► OVERVIEW

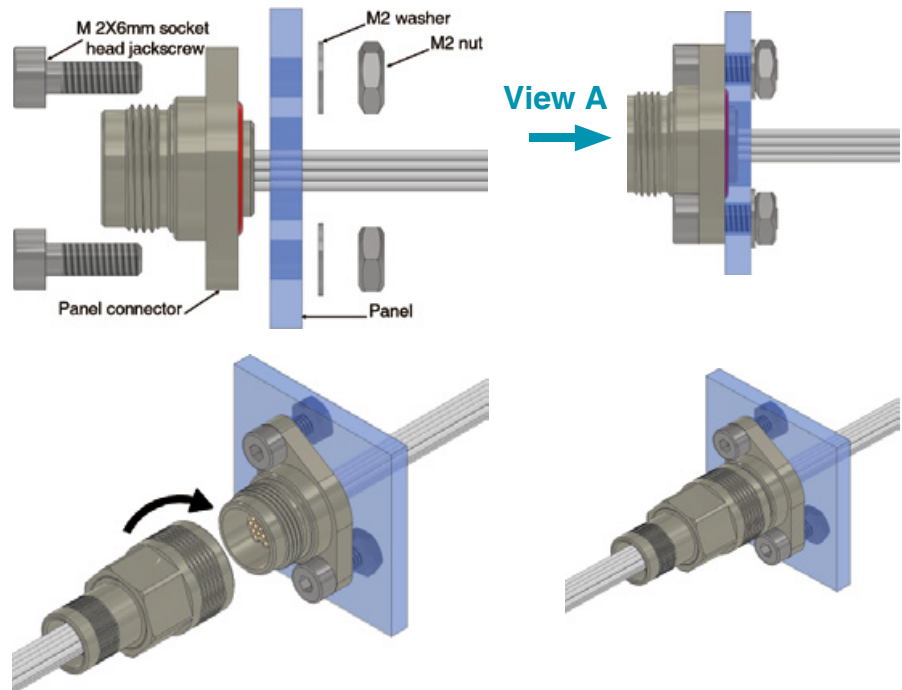

### ► PANEL CUTOUT

SHELL SIZE inch/mm	L4 ± 0.10 (± .0039)	L5 ± 0.10 (± .0039)	ØB -0/+0.10 (-0/ ± .0039)
15 CONTACTS	6.3 (0.248)	11.38 (0.448)	6.3 (0.248)
25 CONTACTS	7.3 (0.287)	11.94 (0.470)	7.3 (0.287)
37 CONTACTS	8.8 (0.346)	12.14 (0.478)	8.5 (0.335)

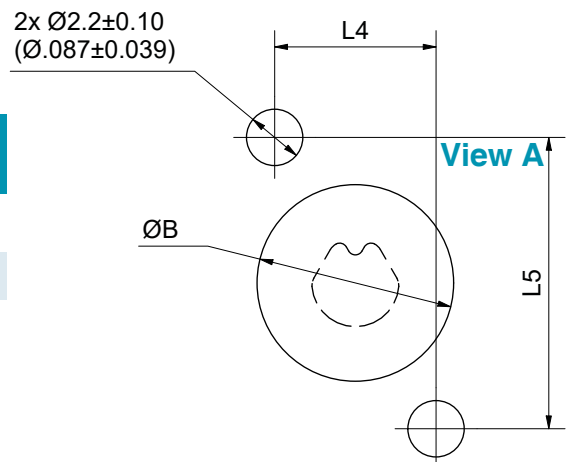

## ► Rear panel mounting (for pigtail or PCB connector)

### ► OVERVIEW

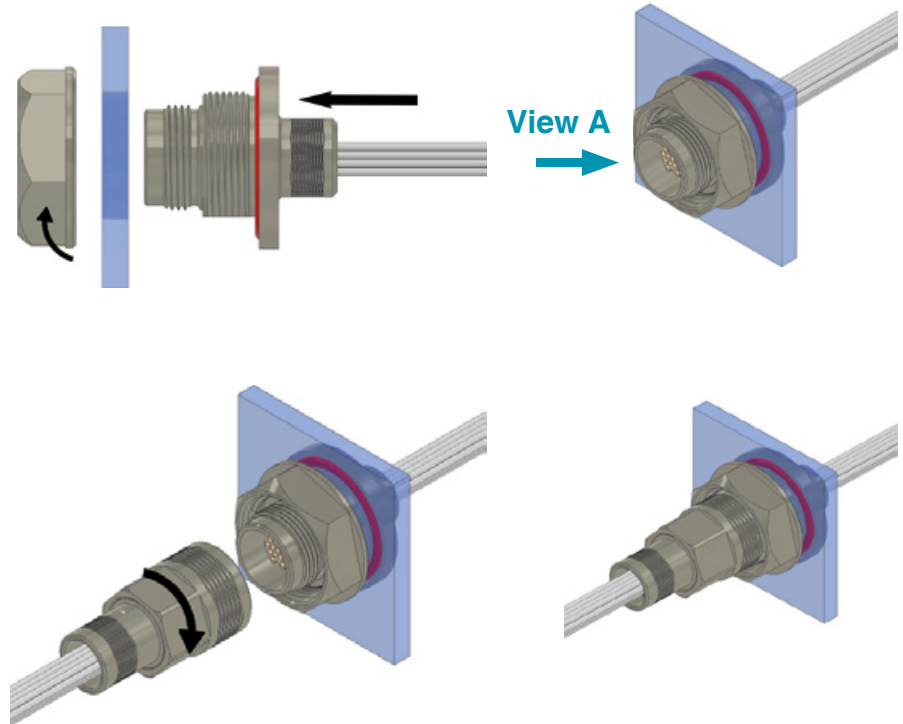

### ► PANEL CUTOUT

SHELL SIZE inch/mm	L5 ± 0.10 (± .0039)	ØE -0/+ 0.10 (-0/+ .0039)
15 CONTACTS	4.70 (0.185)	10.20 (0.402)
25 CONTACTS	5.20 (0.205)	11.20 (0.441)
37 CONTACTS	5.70 (0.224)	12.20 (0.480)

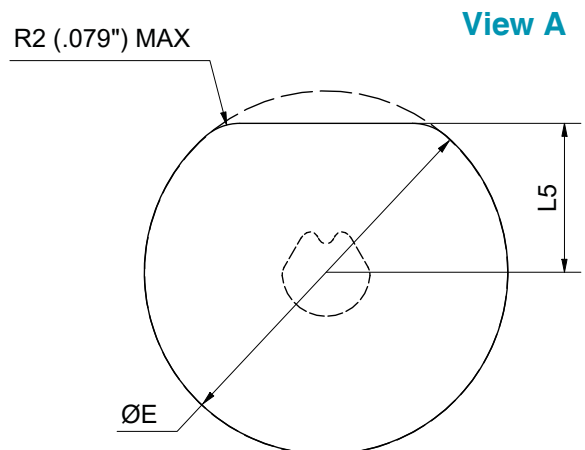

## Recommended torques values

To secure the mating between plug and receptacle connector and Jam nut on the rear panel mount plug connector, please apply these torque values.

MATING TORQUE	JAM NUT ON REAR PANEL MOUNT
0.8 Nm	1 Nm

**ATTENTION:** When panel-mounting PCB connectors be careful not to over-stress the connector PC tails. We recommend the use of a Flexible Printed Circuit (FPC) or a Flex-rigid PCB where possible. We recommend the use of flex PCB or a rigid-flex PCB keying on customer assembly.

## ► Required space for mounting

### ► OVAL SHAPE FRONT PANEL MOUNT

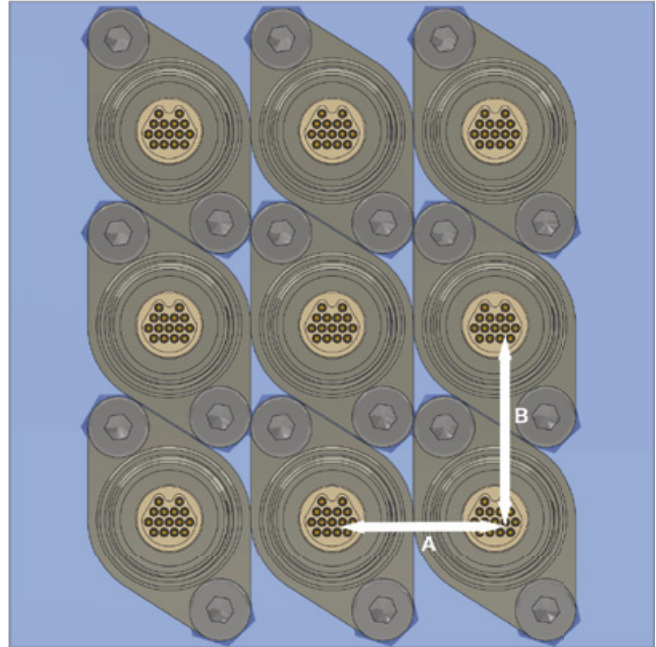

SHELL SIZE inch/mm	A MIN	B MIN
15 CONTACTS	10.1 (.398)	12 (.472)
25 CONTACTS	11.1 (.437)	12.5 (.492)
37 CONTACTS	12.1 (.476)	13.3 (.524)

### ► ROUND SHAPE REAR PANEL MOUNT

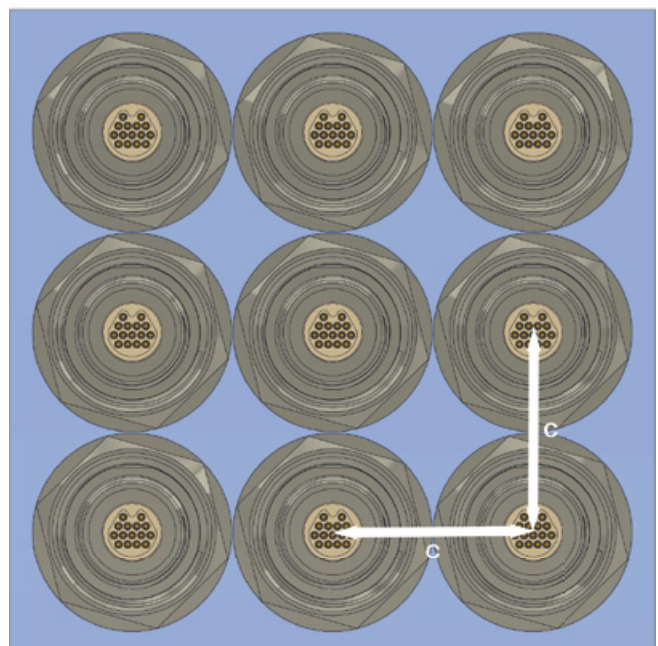

SHELL SIZE inch/mm	C MIN
15 CONTACTS	14 (.551)
25 CONTACTS	15 (.591)
37 CONTACTS	16 (.630)

The above illustrates the minimum possible spacing. In reality the user should ensure there is sufficient space to allow for tightening the nuts with a tool, taking into account the proposed assembly sequence.

# NANO CIRCULAR PCB CONNECTORS

## ► Recommended screws for PCB mounting (#0-80 UNF)

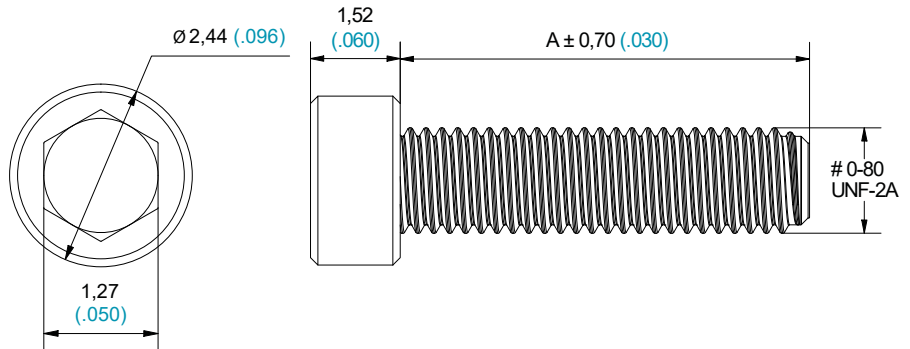

PCB THICKNESS	RECOMMENDED SCREW LENGTH	AXON REF
THICKNESS < 0.80mm (.0315")	3.18mm (1/8")	NDAHMO-80-1/8
0.80mm (.0315") < THICKNESS < 2.4mm (.094")	4.77mm (3/16")	NDAHMO-80-3/16
2.4mm (.094") < THICKNESS	6.35mm (1/4")	NDAHMO-80-1/4

**Recommended torque** for all Nano-D hardware with **0-80 UNF** thread is **0.11 Nm**. We propose a tool package with torque screwdriver & 0.050" hex key for hex screw. See description in our Micro-D & Nano-D catalogue - Part N°: P536692.

## ► Panel mount for PCB-CBR mounting

When rear panel mounting a CBR connector the bottom of the flange will sit lower than the bottom of the PCB, as illustrated here.

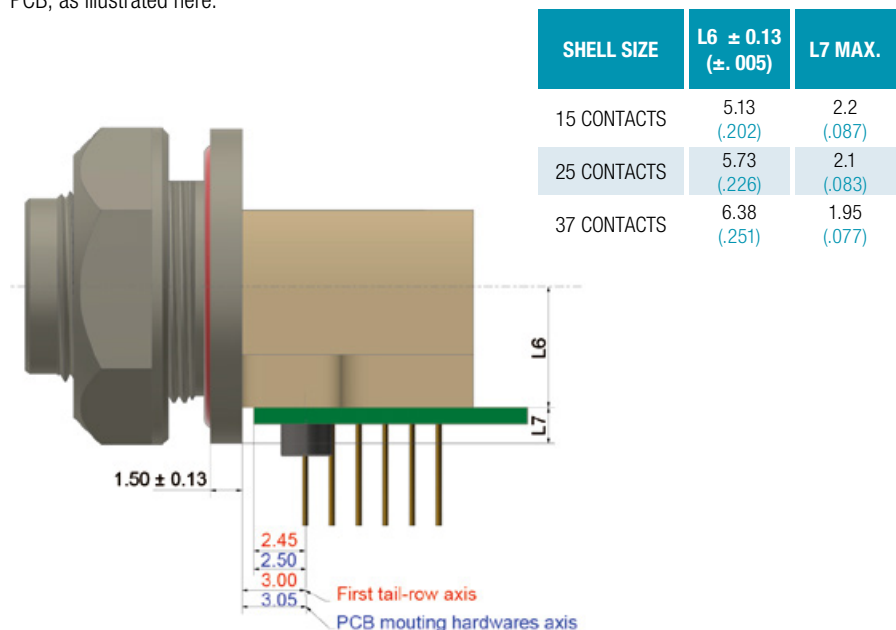

# SWAPPABLE INSERTS

Both female and male inserts can be fitted to either the plug or the receptacle shell. By changing the gender for two otherwise identical connectors close to each other, mating to the wrong connector becomes impossible.

## PLUG CONNECTOR



With female insert (Socket contacts)

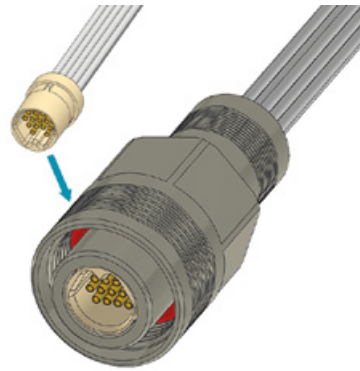

With male insert (Pin contacts)

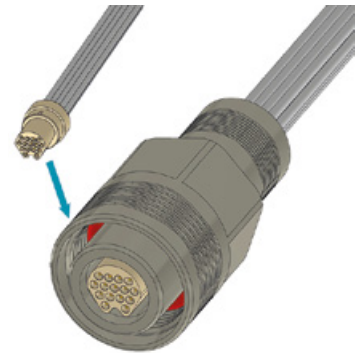

## RECEPTACLE CONNECTOR



With female insert (Socket contacts)

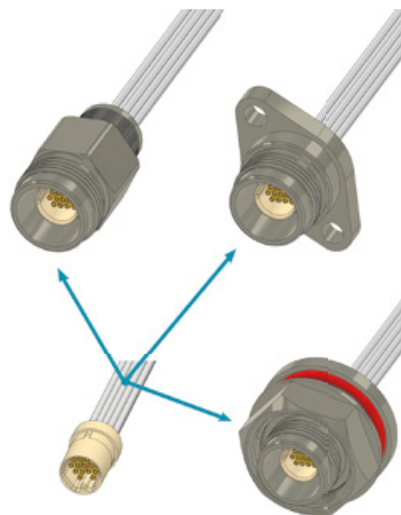

With male insert (Pin contacts)

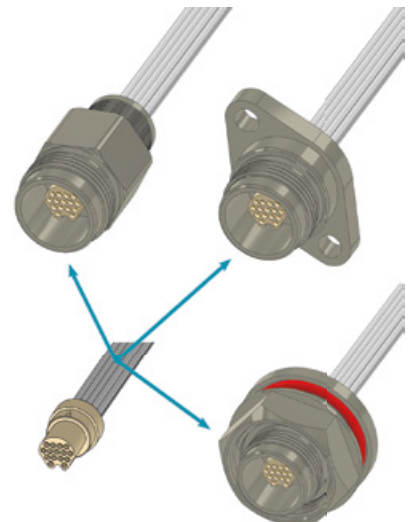

# REACH & ROHS COMPLIANCE

## ▶ RoHS compliance

AXON' CABLE has been pro-actively implementing measures for many years to ensure compliance with the European Directive 2011/65/EU which came into force on 21<sup>st</sup> July 2011.

The Directive prohibits the use of Hazardous Substances such as lead, mercury, hexavalent chromium, cadmium, bromine compounds (PBB and PBDE) and various phthalates.

It relates to all components of products which are used in the manufacture of electrical and electronic equipment.

As a cable and connector manufacturer, AXON' has taken actions to ensure compliance with directive 2000/53/EC applicable since 21<sup>st</sup> October 2000.

### SPECIFIC COMPONENTS FOR RoHS COMPLIANCE

COMPONENT	MATERIAL	FINISH	ROHS STATUS
PIN CONTACT (TWIST PIN)	Gold alloy	N/A	Compliant
SOCKET CONTACT	Gold alloy	N/A	Compliant
METAL SHELL	Aluminium alloy type 6061	Electroless nickel	Compliant
PLASTIC INSERT/ PCB TRAY	PEEK or LCP	N/A	Compliant
CLIP	Stainless steel 300 series	Passivation	Compliant
PCB TERMINATION	Copper based alloy	Gold	Compliant
ENCAPSULANT	Epoxy resin 150°C version	N/A	Compliant
O-RING/PANEL SEAL	Silicone MVQ	N/A	Compliant

## ▶ Application of REACH

The new EU regulation on the Registration, Evaluation, Authorization and restriction of Chemicals (REACH) came into force in June 2007.

The regulation concerns the authorized use of chemicals. It requires manufacturers and importers to register substances and their use with the European Chemical Agency (ECHA).

AXON' CABLE is known as a «downstream user» with respect to the REACH regulation, and a manufacturer of «Articles». AXON' CABLE products are not intended to release any undesired substance under normal and reasonable operations of use.

At time of publication AXON' CABLE has not identified any component containing any SVHC in the Nano Circular range.

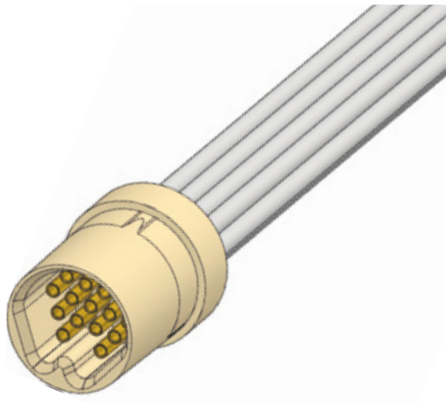

NCA P 15 F 4 W 050

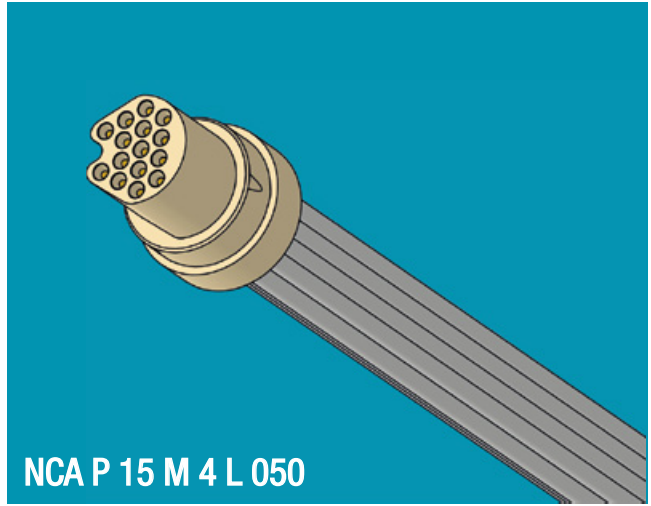

NCA P 15 M 4 L 050

# NANO CIRCULAR PLASTIC PIGTAIL

## IDENTIFICATION CODE

**NCA**

**P**

**25**

**F**

**4**

**W**

**050**

### SERIES

**NCA:** Nano circular AXON<sup>®</sup>.

### MATERIAL & FINISH

**P:** Plastic.

### NUMBER OF CONTACTS

**15, 25, 37.**

### CONTACTS GENDER

**F:** Socket contacts.

**M:** Pin contacts.

### WIRES TYPE

- 1:** ET3007, AWG30, 7 strands, 250V
- 2:** ET3207, AWG32, 7 strands, 250V
- 3:** ET3407, AWG34, 7 strands, 250V
- 4:** ET3607, AWG36, 7 strands, 250V

### COLOUR CODE

**L:** White

**F:** Yellow

**W:** 10 colour repeat

### WIRE LENGTH (in cm)

**ATTENTION!** Wire length in centimeters  
(1cm = 10mm = 0.394")

L	2 ≤ L ≤ 10	10 < L ≤ 100	L > 100
in cm (inches)	0.79 ≤ L ≤ 3.940	3.940 < L ≤ 39.40	L > 39.40
TOLERANCE	-0 / +0.5	-0 / +3	-0 / +5
in cm (inches)	-0 / +0.200	-0 / +1.180	-0 / +1.970

NUMBER INCH/MM	15 CONTACTS	25 CONTACTS	37 CONTACTS
ØA ±0.13 (± .005)	4.70 (0.185)	5.70 (0.224)	6.80 (0.268)

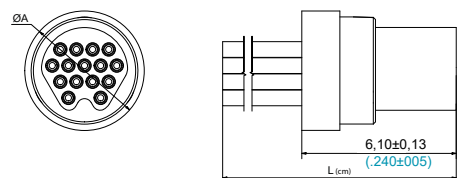
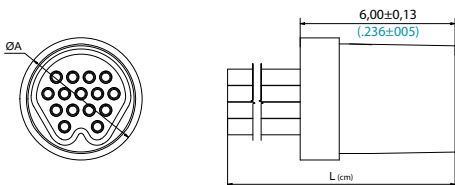

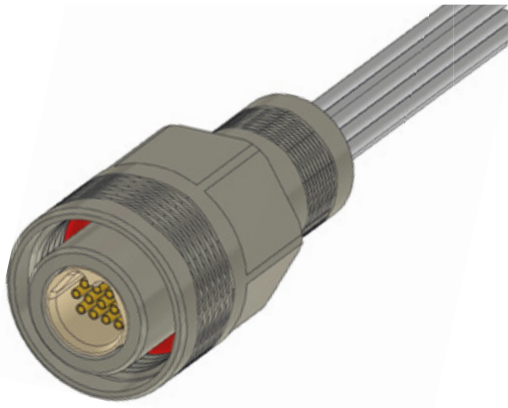

NCA TH 2 15 F P IB 4 L 050 R

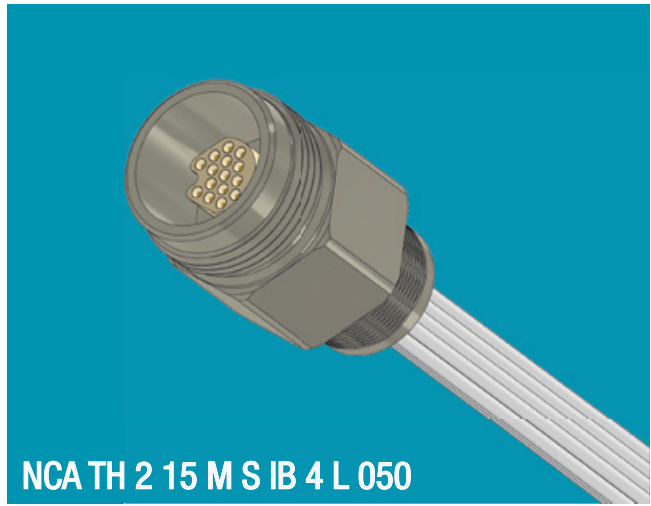

NCA TH 2 15 M S IB 4 L 050

# NANO CIRCULAR PIGTAIL CONNECTORS

## IDENTIFICATION CODE



### SERIES

**NCA:** Nano circular Axon' Solution

### LOCKING

**TH:** Metric Thread

### MATERIAL AND FINISH

**2:** Aluminium with electroless nickel plating and epoxy 150°C

### NUMBER OF WAYS

**15, 25, 37**

### CONTACTS GENDER

**F:** Socket contacts - **M:** Pin contacts

### SHELL GENDER

**S:** Receptacle - **P:** Plug

### SHELL STYLE

**IL:** In-Line shell

**IB:** In-Line with integrated backshell

**OF:** Front mount Oval flange (receptacle only)

**JB:** Jam Nut Rear mount flange with integrated backshell (receptacle only)

**JR:** Jam nut Rear mount flange (receptacle only)

### WIRE TYPE

**1:** ET3007 - AWG30, 7 strands - 250 V

**2:** ET3207 - AWG32, 7 strands - 250 V

**3:** ET3407 - AWG34, 7 strands - 250 V

**4:** ET3607 - AWG36, 7 strands - 250 V

### COLOUR CODE

**L:** White - **F:** Yellow - **W:** 10 colour repeat

### WIRE LENGTH (in cm)

(1cm = 10mm = 0.394)

L	2 ≤ L ≤ 10	10 < L ≤ 100	L > 100
in cm (inches)	0.79 ≤ L ≤ 3.940	3.940 < L ≤ 39.40	L > 39.40
TOLERANCE	-0 / +0.5	-0 / +3	-0 / +5
in cm (inches)	-0 / +0.200	-0 / +1.180	-0 / +1.970

### O-RING OPTION (PLUG ONLY)

**R:** with O-ring - **blank:** without O-ring

# PIGTAIL IN-LINE (Code IL)

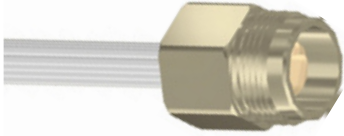

## DIMENSIONS

Dimensions are in millimetres (inches).

### RECEPTACLE CONNECTOR (CODE S)

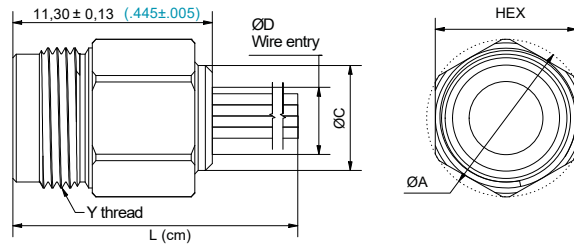

### PLUG CONNECTOR (CODE P)

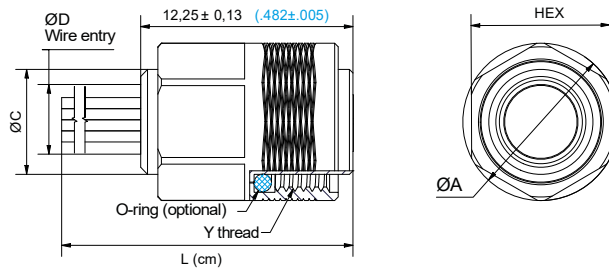

SHELL SIZE INCH/MM	ØA ± 0.13 (± .005)	ØC±0.13 (± .005)	ØD±0.13 (± .005)	HEX	Y THREAD
15 CONTACTS	9.00 (0.354)	6.00 (0.236)	4.80 (0.189)	8.00 (0.315)	m8x0.5 (-)
25 CONTACTS	10.00 (0.394)	7.00 (0.276)	5.80 (0.228)	9.00 (0.354)	m9x0.5 (-)
37 CONTACTS	11.00 (0.433)	8.00 (0.315)	6.95 (0.274)	10.00 (0.394)	m10x0.5 (-)

## Summary of characteristics

ELECTRICAL & MECHANICAL PERFORMANCE	
CURRENT RATING	1 A max.
CONTACT RESISTANCE	71 mΩ max.
INSULATION RESISTANCE	5000 MΩ min. @ 100 V <sub>bc</sub>
DIELECTRIC WITHSTANDING VOLTAGE	Sea level: 250 V <sub>ac</sub>
	Altitude 21 km (70,000ft): 100 V <sub>ac</sub>
CONTACT ENGAGING FORCE	141 g max. (5oz.)
CONTACT SEPARATING FORCE	11 g min. (0.4oz.)
CONTACT RETENTION	0.9 kg (2 lbs)
DURABILITY	200 mating cycles min.
VIBRATION	20g's – no discontinuity > 1µs
SHOCK	100g's – no discontinuity > 1µs

MATERIAL AND FINISH	
SHELL	Aluminium Alloy 7075 nickel plated
MOLDED INSULATOR	PEEK
PIN CONTACTS	Gold Alloy
SOCKET CONTACTS	Gold Alloy
ENCAPSULANT	Epoxy Resin
OPTIONAL ORING	Silicone MVQ

## Recommended torque values

To secure the mating between plug and receptacle connector and Jam nut on the receptacle rear panel mount connector, please apply these torque values.

MATING TORQUE	JAM NUT ON REAR PANEL MOUNT
0.8 Nm	1 Nm

# PIGTAIL IN-LINE WITH BACKSHELL (Code IB)

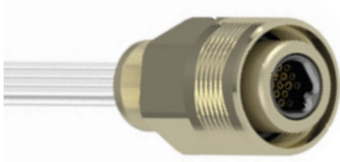

## DIMENSIONS

Dimensions are in millimetres (inches).

### RECEPTACLE CONNECTOR (CODE S)

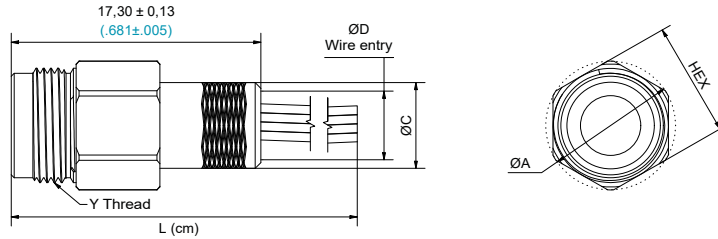

### PLUG CONNECTOR (CODE P)

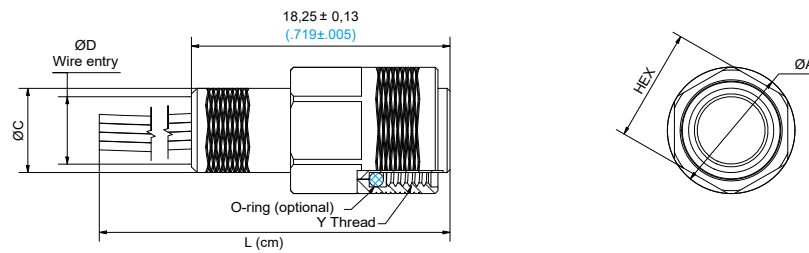

SHELL SIZE INCH/MM	ØA ± 0.13 (± .005)	ØC ± 0.13 (± .005)	ØD ± 0.13 (± .005)	HEX	Y THREAD
15 CONTACTS	9.00 (0.354)	6.00 (0.236)	4.80 (0.189)	8.00 (0.315)	m8x0.5 (-)
25 CONTACTS	10.00 (0.394)	7.00 (0.276)	5.80 (0.228)	9.00 (0.354)	m9x0.5 (-)
37 CONTACTS	11.00 (0.433)	8.00 (0.315)	6.95 (0.274)	10.00 (0.394)	m10x0.5 (-)

## Summary of characteristics

### ELECTRICAL & MECHANICAL PERFORMANCE

CURRENT RATING	1 A max.
CONTACT RESISTANCE	71 mΩ max.
INSULATION RESISTANCE	5000 MΩ min. @ 100 V <sub>DC</sub>
DIELECTRIC WITHSTANDING VOLTAGE	Sea level: 250 V <sub>AC</sub>
	Altitude 21 km (70,000ft): 100 V <sub>AC</sub>
CONTACT ENGAGING FORCE	141 g max. (5oz.)
CONTACT SEPARATING FORCE	11 g min. (0.4oz.)
CONTACT RETENTION	0.9 kg (2 lbs)
DURABILITY	200 mating cycles min.
VIBRATION	20g's – no discontinuity > 1µs
SHOCK	100g's – no discontinuity > 1µs

### MATERIAL AND FINISH

SHELL	Aluminium Alloy 7075 nickel plated
MOLDED INSULATOR	PEEK
PIN CONTACTS	Gold Alloy
SOCKET CONTACTS	Gold Alloy
ENCAPSULANT	Epoxy Resin
OPTIONAL ORING	Silicone MVQ

## Recommended torque values

To secure the mating between plug and receptacle connector and Jam nut on the rear panel mount receptacle connector, please apply rear panel mount receptacle connector.

### MATING TORQUE

0.8 Nm

### JAM NUT ON REAR PANEL MOUNT

1 Nm



# PIGTAIL

## FRONT MOUNT OVAL FLANGE (Code OF)

### DIMENSIONS

Dimensions are in millimetres (inches).

#### FRONT MOUNT

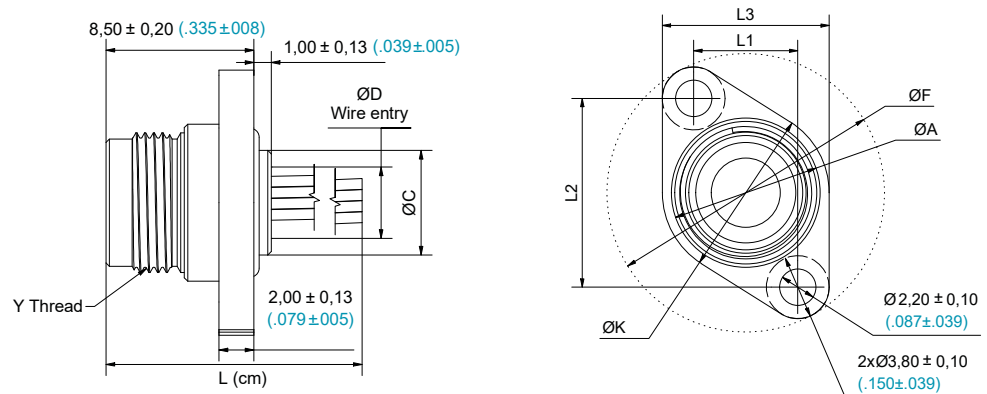

SHELL SIZE INCH/MM	ØA ± 0.15 (± .006)	ØC ± 0.13 (± .005)	ØD ± 0.13 (± .005)	ØK ± 0.13 (± .008)	ØF ± 0.13 (± .005)	L1 ± 0.13 (± .005)	L2 ± 0.13 (± .005)	L3 ± 0.13 (± .008)	Y THREAD
15 CONTACTS	9.00 (0.354)	6.00 (0.236)	4.80 (0.189)	10.1 (0.398)	16.8 (0.661)	6.3 (0.248)	11.38 (0.448)	10.1 (0.398)	m8x0.5 (-)
25 CONTACTS	10.00 (0.394)	7.00 (0.276)	5.80 (0.228)	11.1 (0.437)	17.8 (0.701)	7.3 (0.287)	11.94 (0.470)	11.1 (0.437)	m9x0.5 (-)
37 CONTACTS	11.00 (0.433)	8.00 (0.315)	6.95 (0.274)	12.6 (0.496)	18.8 (0.740)	8.8 (0.346)	12.14 (0.478)	12.6 (0.496)	m10x0.5 (-)

## Summary of characteristics

ELECTRICAL & MECHANICAL PERFORMANCE	
CURRENT RATING	1 A max.
CONTACT RESISTANCE	71 mΩ max.
INSULATION RESISTANCE	5000 MΩ min. @ 100 Vdc
DIELECTRIC WITHSTANDING VOLTAGE	Sea level: 250 Vac
	Altitude 21 km (70,000ft): 100 Vac
CONTACT ENGAGING FORCE	141 g max. (5oz.)
CONTACT SEPARATING FORCE	11 g min. (0.4oz.)
CONTACT RETENTION	0.9 kg (2 lbs)
DURABILITY	200 mating cycles min.
VIBRATION	20g's – no discontinuity > 1µs
SHOCK	100g's – no discontinuity > 1µs

MATERIAL AND FINISH	
SHELL	Aluminium Alloy 7075 nickel plated
MOLDED INSULATOR	PEEK
PIN CONTACTS	Gold Alloy
SOCKET CONTACTS	Gold Alloy
ENCAPSULANT	Epoxy Resin
PANEL SEAL	Silicone MVQ

## Recommended torque values

To secure the mating between plug and receptacle connector and Jam nut on the rear panel mount receptacle connector, please apply rear panel mount receptacle connector.

MATING TORQUE	JAM NUT ON REAR PANEL MOUNT
0.8 Nm	1 Nm

# PIGTAIL

## JAM NUT REAR MOUNT WITH BACKSHELL (Code JB)



### DIMENSIONS

Dimensions are in millimetres (inches).

#### REAR MOUNT

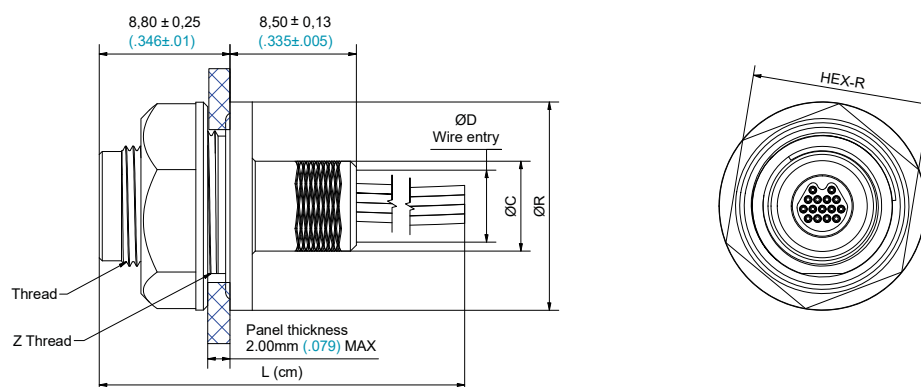

SHELL SIZE INCH/MM	ØR±0.13 (± .005)	ØC±0.13 (± .005)	ØD±0.13 (± .005)	HEX-R	Y THREAD	Z THREAD
15 CONTACTS	13.90 (0.547)	6.00 (0.236)	4.80 (0.189)	12.00 (0.472)	m8x0.5 (-)	m10x0.5 (-)
25 CONTACTS	14.90 (0.587)	7.00 (0.276)	5.80 (0.228)	13.00 (0.512)	m9x0.5 (-)	m11x0.5 (-)
37 CONTACTS	15.90 (0.626)	8.00 (0.315)	6.95 (0.274)	14.00 (0.551)	m10x0.5 (-)	m12x0.5 (-)

## Summary of characteristics

#### ELECTRICAL & MECHANICAL PERFORMANCE

CURRENT RATING	1 A max.
CONTACT RESISTANCE	71 mΩ max.
INSULATION RESISTANCE	5000 MΩ min. @ 100 Vdc)
DIELECTRIC WITHSTANDING VOLTAGE	Sea level: 250 Vac
	Altitude 21 km (70,000ft): 100 Vac
CONTACT ENGAGING FORCE	141 g max. (5oz.)
CONTACT SEPARATING FORCE	11 g min. (0.4oz.)
CONTACT RETENTION	0.9 kg (2 lbs)
DURABILITY	200 mating cycles min.
VIBRATION	20g's – no discontinuity > 1µs
SHOCK	100g's – no discontinuity > 1µs

#### MATERIAL AND FINISH

SHELL	Aluminium Alloy 7075 nickel plated
MOLDED INSULATOR	PEEK
PIN CONTACTS	Gold Alloy
SOCKET CONTACTS	Gold Alloy
ENCAPSULANT	Epoxy Resin
PANEL SEAL	Silicone MVQ

## Recommended torque values

To secure the mating between plug and receptacle connector and Jam nut on the rear panel mount receptacle connector, please apply rear panel mount receptacle connector.

#### MATING TORQUE

0.8 Nm

#### JAM NUT ON REAR PANEL MOUNT

1 Nm

# PIGTAIL

## JAM NUT REAR MOUNT (Code JR)



### DIMENSIONS

Dimensions are in millimetres (inches).

#### REAR MOUNT

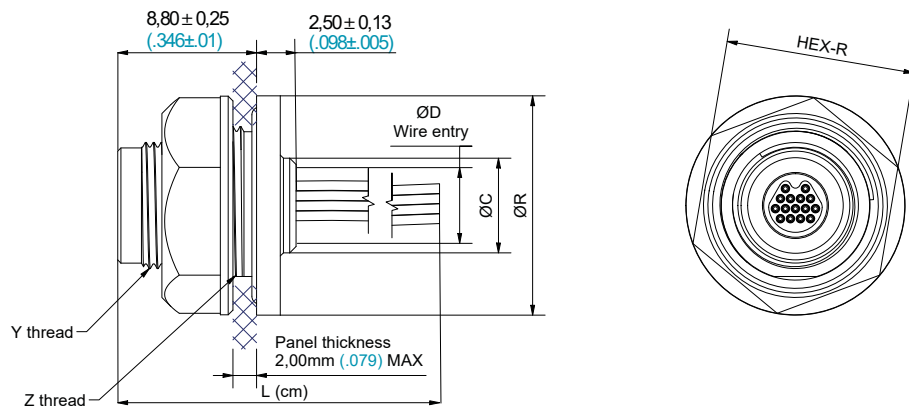

SHELL SIZE INCH/MM	ØR ± 0.13 (± .005)	ØC ± 0.13 (± .005)	ØD ± 0.13 (± .005)	HEX-R	Y THREAD	Z THREAD
15 CONTACTS	13.90 (0.547)	6.00 (0.236)	4.80 (0.189)	12.00 (0.472)	m8x0.5 (-)	m10x0.5 (-)
25 CONTACTS	14.90 (0.587)	7.00 (0.276)	5.80 (0.228)	13.00 (0.512)	m9x0.5 (-)	m11x0.5 (-)
37 CONTACTS	15.90 (0.626)	8.00 (0.315)	6.95 (0.274)	14.00 (0.551)	m10x0.5 (-)	m12x0.5 (-)

## Summary of characteristics

#### ELECTRICAL & MECHANICAL PERFORMANCE

CURRENT RATING	1 A max.
CONTACT RESISTANCE	71 mΩ max.
INSULATION RESISTANCE	5000 MΩ min. @ 100 Vdc
DIELECTRIC WITHSTANDING VOLTAGE	Sea level: 250 VAC
	Altitude 21 km (70,000ft): 100 VAC
CONTACT ENGAGING FORCE	141 g max. (5oz.)
CONTACT SEPARATING FORCE	11 g min. (0.4oz.)
CONTACT RETENTION	0.9 kg (2 lbs)
DURABILITY	200 mating cycles min.
VIBRATION	20g's – no discontinuity > 1µs
SHOCK	100g's – no discontinuity > 1µs

#### MATERIAL AND FINISH

SHELL	Aluminium Alloy 7075 nickel plated
MOLDED INSULATOR	PEEK
PIN CONTACTS	Gold Alloy
SOCKET CONTACTS	Gold Alloy
ENCAPSULANT	Epoxy Resin
PANEL SEAL	Silicone MVQ

## Recommended torque values

To secure the mating between plug and receptacle connector and Jam nut on the rear panel mount receptacle connector, please apply rear panel mount receptacle connector.

MATING TORQUE	JAM NUT ON REAR PANEL MOUNT
0.8 Nm	1 Nm

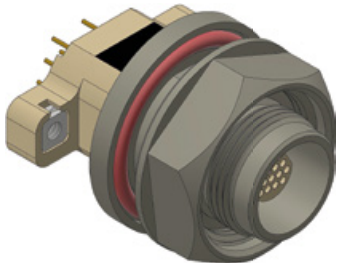

NCA TH 2 15 M S JR BS G 2

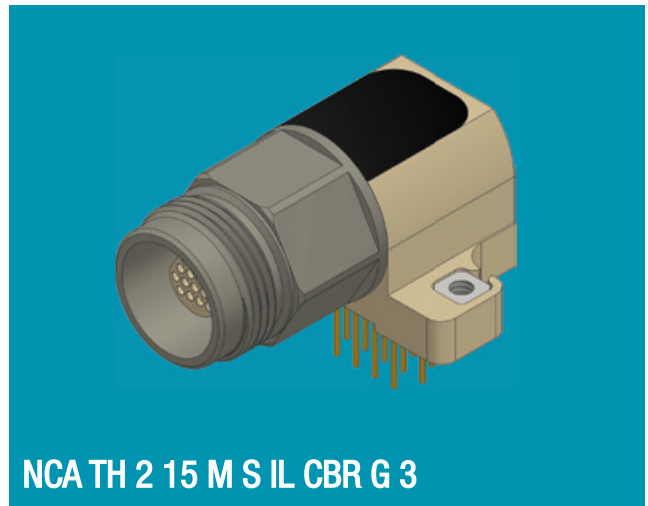

NCA TH 2 15 M S IL CBR G 3

# NANO CIRCULAR PCB CONNECTORS

## IDENTIFICATION CODE

NCA	TH	2	15	F	P	IL	CBR	G	1
-----	----	---	----	---	---	----	-----	---	---

### SERIES

**NCA:** Nano circular Axon' Solution

### LOCKING

**TH:** Metric Thread

### MATERIAL AND FINISH

**2:** Aluminium with electroless nickel plating and epoxy 150°C

### NUMBER OF WAYS

**15, 25, 37**

### CONTACTS GENDER

**F:** Socket contacts

**M:** Pin contacts

### SHELL GENDER

**S:** Receptacle

### SHELL STYLE

**IL:** In-Line shell

**JR:** Jam nut Rear mount flange

### PCB TYPE

**CBR:** Condensed board Right Angle

**BS:** Board Straight

### TAIL PLATING

**D:** Gold flash plated solid conductor  
AWG30 - degolding free

**G:** Gold plated solid conductor AWG30

### TAIL LENGTH

**1:** 2.77mm (0.109")

**2:** 3.56mm (0.140")

**3:** 4.37mm (0.172")

**4:** 2.29mm (0.090")

Tolerance: ± 0.25mm (0.010")

# PCB CBR IN-LINE (IL)

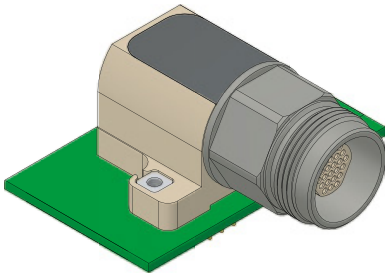

## DIMENSIONS

Dimensions are in millimetres (inches).

### CBR IN LINE SHAPE

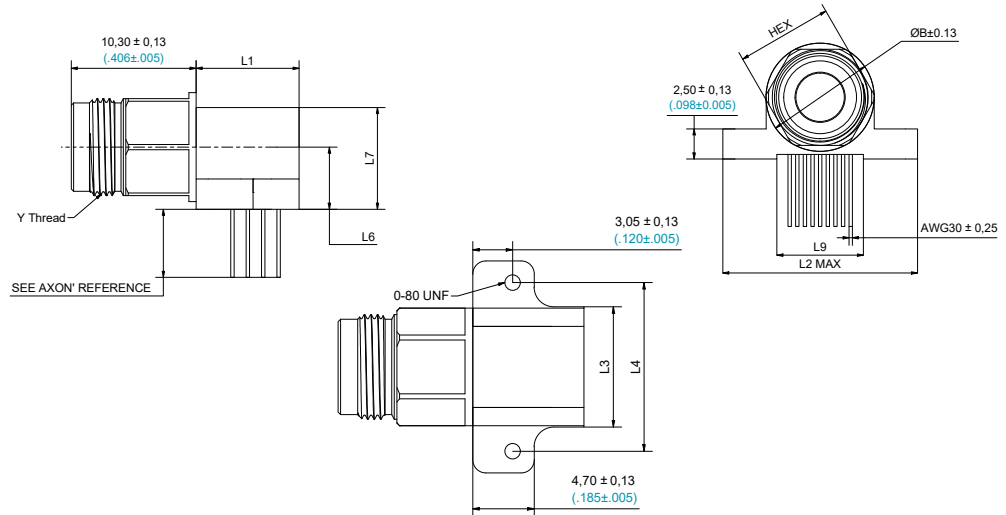

SHELL SIZE	ØB ± 0.13 (± .005)	L1 ± 0.13 (± .005)	L2 MAX	L3 ± 0.13 (± .005)	L4 ± 0.13 (± .005)	L6 ± 0.13 (± .005)	L7 ± 0.20 (± .008)	L9 ± 0.13 (± .005)	HEX	Y THREAD
15	9.00 (0.354)	8.50 (0.335)	16.50 (0.650)	9.20 (0.362)	12.90 (0.508)	5.13 (0.202)	8.40 (0.331)	7.20 (0.283)	8.00 (0.315)	m8x0.5 (-)
25	10.20 (0.402)	11.00 (0.433)	17.70 (0.697)	10.40 (0.697)	14.10 (0.555)	5.73 (0.226)	9.40 (0.370)	8.40 (0.331)	9.00 (0.354)	m9x0.5 (-)
37	11.50 (0.453)	13.30 (0.524)	19.00 (0.748)	11.70 (0.461)	15.40 (0.606)	6.38 (0.251)	10.40 (0.409)	9.70 (0.382)	10.00 (0.394)	m10x0.5 (-)

## Summary of characteristics

ELECTRICAL & MECHANICAL PERFORMANCE	
CURRENT RATING	1 A max.
CONTACT RESISTANCE	71 mΩ max.
INSULATION RESISTANCE	5000 MΩ min. @ 100 Vdc)
DIELECTRIC WITHSTANDING VOLTAGE	Sea level: 250 V <sub>ac</sub>
	Altitude 21 km (70,000ft): 100 V <sub>ac</sub>
CONTACT ENGAGING FORCE	141 g max. (5oz.)
CONTACT SEPARATING FORCE	11 g min. (0.4oz.)
CONTACT RETENTION	0.9 kg (2 lbs)
DURABILITY	200 mating cycles min.
VIBRATION	20g's – no discontinuity > 1µs
SHOCK	100g's – no discontinuity > 1µs

MATERIAL AND FINISH	
SHELL	Aluminium Alloy 7075 nickel plated
MOLDED INSULATOR	PEEK
PIN CONTACTS	Gold Alloy
SOCKET CONTACTS	Gold Alloy
ENCAPSULANT	Epoxy Resin
PCB TRAY	PEEK or LCP
UNINSULATED	Gold plated solid copper alloy wire
HARDWARE	Stainless steel 300 series

## Recommended torque values

To secure the mating between plug and receptacle connector and Jam nut on the rear panel mount receptacle connector, please apply rear panel mount receptacle connector.

MATING TORQUE	JAM NUT ON REAR PANEL MOUNT
0.8 Nm	1 Nm

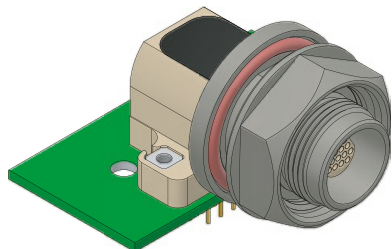

# PCB

## CBR JAM NUT REAR MOUNT (JR)

### DIMENSIONS

Dimensions are in millimetres (inches).

#### CBR PANEL REAR MOUNT

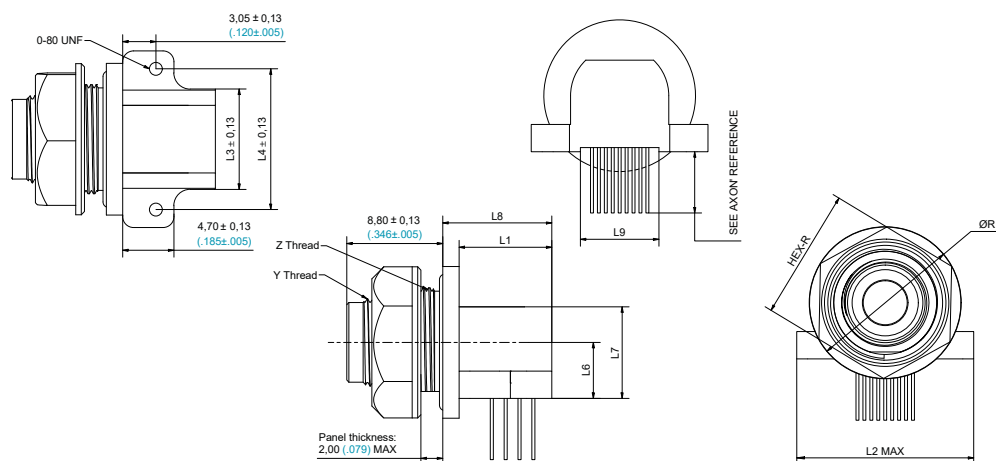

SHELL SIZE	ØR ± 0.13 (± .005)	L1 ± 0.13 (± .005)	L2 MAX	L3 ± 0.13 (± .005)	L4 ± 0.13 (± .005)	L6 ± 0.13 (± .005)	L7 ± 0.20 (± .008)	L8 ± 0.20 (± .008)	L9 ± 0.13 (± .005)	HEX-R	Y THREAD	Z THREAD
15	13.90 (0.547)	8.50 (0.335)	16.50 (0.650)	9.20 (0.362)	12.90 (0.508)	5.13 (0.202)	8.40 (0.331)	10.00 (0.283)	7.20 (0.283)	12.00 (0.472)	M8x0.5 (-)	M10x0.5 (-)
25	14.90 (0.587)	11.00 (0.433)	17.70 (0.697)	10.40 (0.697)	14.10 (0.555)	5.73 (0.226)	9.40 (0.370)	12.50 (0.492)	8.40 (0.331)	13.00 (0.512)	M9x0.5 (-)	M11x0.5 (-)
37	15.90 (0.626)	13.30 (0.524)	19.00 (0.748)	11.70 (0.461)	15.40 (0.606)	6.38 (0.251)	10.40 (0.409)	14.80 (0.583)	9.70 (0.382)	14.00 (0.551)	M10x0.5 (-)	M12x0.5 (-)

## Summary of characteristics

ELECTRICAL & MECHANICAL PERFORMANCE	
CURRENT RATING	1 A max.
CONTACT RESISTANCE	71 mΩ max.
INSULATION RESISTANCE	5000 MΩ min. @ 100 V <sub>DC</sub>
DIELECTRIC WITHSTANDING VOLTAGE	Sea level: 250 V <sub>AC</sub> Altitude 21 km (70,000ft): 100 V <sub>AC</sub>
CONTACT ENGAGING FORCE	141 g max. (5oz.)
CONTACT SEPARATING FORCE	11 g min. (0.4oz.)
CONTACT RETENTION	0.9 kg (2 lbs)
DURABILITY	200 mating cycles min.
VIBRATION	20g's – no discontinuity > 1µs
SHOCK	100g's – no discontinuity > 1µs

MATERIAL AND FINISH	
SHELL	Aluminium Alloy 7075 nickel plated
MOLDED INSULATOR	PEEK
PIN CONTACTS	Gold Alloy
SOCKET CONTACTS	Gold Alloy
ENCAPSULANT	Epoxy Resin
PANEL SEAL	Silicone MVQ
PCB TRAY	PEEK or LCP
UNINSULATED	Gold plated solid copper alloy wire
HARDWARE	Stainless steel 300 series

## Recommended torque values

To secure the mating between plug and receptacle connector and Jam nut on the rear panel mount receptacle connector, please apply rear panel mount receptacle connector.

MATING TORQUE	JAM NUT ON REAR PANEL MOUNT
0.8 Nm	1 Nm

# PCB BS IN-LINE (IL)

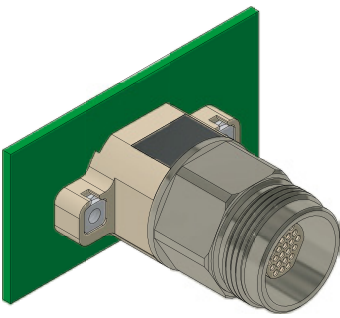

## DIMENSIONS

Dimensions are in millimetres (inches).

### CBR IN LINE SHAPE

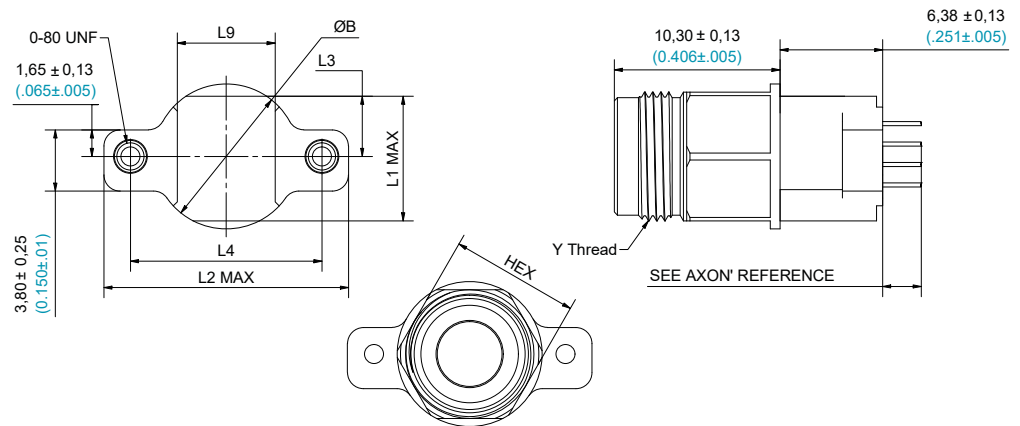

SHELL SIZE	ØB ± 0.13 (± .005)	L1 MAX	L2 MAX	L3 ± 0.13 (± .005)	L4 ± 0.13 (± .005)	L9 ± 0.13 (± .008)	HEX	Y THREAD
15	9.00 (0.354)	7.90 (0.275)	15.50 (0.590)	3.75 (0.118)	11.90 (0.433)	6.08 (0.236)	8.00 (0.315)	m8x0.5 (-)
25	10.20 (0.402)	8.95 (0.314)	16.50 (0.629)	4.30 (0.157)	12.90 (0.507)	7.35 (0.275)	9.00 (0.354)	m9x0.5 (-)
37	11.50 (0.453)	10.70 (0.393)	17.50 (0.669)	5.20 (0.196)	13.90 (0.511)	8.00 (0.314)	10.00 (0.394)	m10x0.5 (-)

## Summary of characteristics

ELECTRICAL & MECHANICAL PERFORMANCE	
CURRENT RATING	1 A max.
CONTACT RESISTANCE	71 mΩ max.
INSULATION RESISTANCE	5000 MΩ min. @ 100 V <sub>DC</sub>
DIELECTRIC WITHSTANDING VOLTAGE	Sea level: 250 V <sub>AC</sub> Altitude 21 km (70,000ft): 100 V <sub>AC</sub>
CONTACT ENGAGING FORCE	141 g max. (5oz.)
CONTACT SEPARATING FORCE	11 g min. (0.4oz.)
CONTACT RETENTION	0.9 kg (2 lbs)
DURABILITY	200 mating cycles min.
VIBRATION	20g's – no discontinuity > 1µs
SHOCK	100g's – no discontinuity > 1µs

MATERIAL AND FINISH	
SHELL	Aluminium Alloy 7075 nickel plated
MOLDED INSULATOR	PEEK
PIN CONTACTS	Gold Alloy
SOCKET CONTACTS	Gold Alloy
ENCAPSULANT	Epoxy Resin
PCB TRAY	PEEK or LCP
UNINSULATED	Gold plated solid copper alloy wire
HARDWARE	Stainless steel 300 series

## Recommended torque values

To secure the mating between plug and receptacle connector and Jam nut on the rear panel mount receptacle connector, please apply rear panel mount receptacle connector.

MATING TORQUE	JAM NUT ON REAR PANEL MOUNT
0.8 Nm	1 Nm

# PCB

## BS JAM NUT REAR MOUNT (JR)

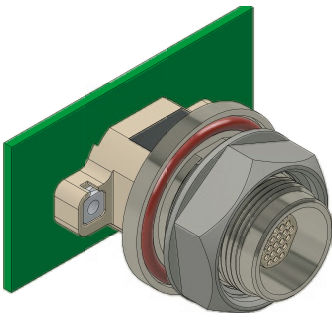

### DIMENSIONS

Dimensions are in millimetres (inches).

#### CBR PANEL REAR MOUNT

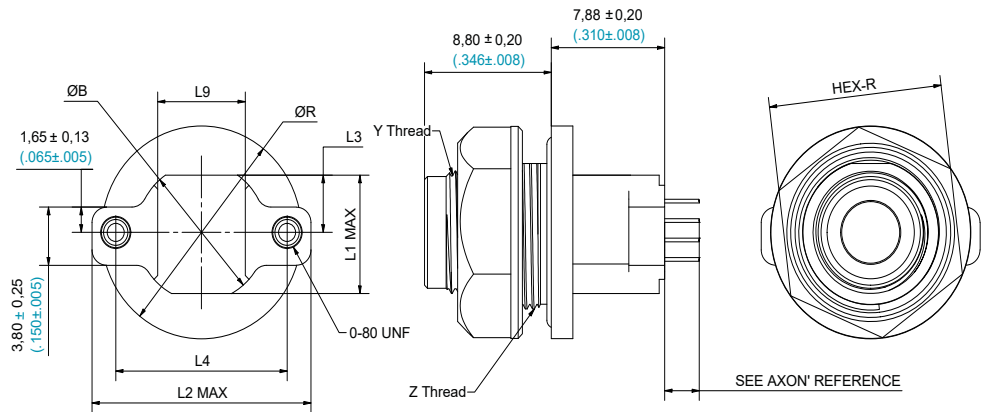

SHELL SIZE	ØB ± 0.13 (±.006)	ØR ± 0.13 (±.006)	L1 MAX	L2 MAX	L3 ± 0.13 (±.006)	L4 ± 0.13 (±.005)	L9 ± 0.13 (±.005)	HEX	Y THREAD	Z THREAD
15	9.00 (0.354)	13.90 (0.547)	7.90 (0.311)	15.50 (0.610)	3.75 (0.148)	11.90 (0.469)	6.08 (0.239)	12 (0.472)	m8x0.5 (-)	m10x0.5 (-)
25	10.20 (0.402)	14.90 (0.587)	8.95 (0.352)	16.50 (0.650)	4.30 (0.169)	12.90 (0.508)	7.35 (0.289)	13.00 (0.512)	m9x0.5 (-)	m11x0.5 (-)
37	11.50 (0.453)	15.90 (0.626)	10.70 (0.421)	17.50 (0.689)	5.20 (0.205)	13.90 (0.547)	8.00 (0.315)	14.00 (0.551)	m10x0.5 (-)	m12x0.5 (-)

## Summary of characteristics

ELECTRICAL & MECHANICAL PERFORMANCE	
CURRENT RATING	1A max.
CONTACT RESISTANCE	71mΩ max.
INSULATION RESISTANCE	5000 MΩ min. @ 100 V <sub>DC</sub>
DIELECTRIC WITHSTANDING VOLTAGE	Sea level: 250 V <sub>AC</sub>
	Altitude 21 km (70,000ft): 100 V <sub>AC</sub>
CONTACT ENGAGING FORCE	141 g max. (5oz.)
CONTACT SEPARATING FORCE	11 g min. (0.4oz.)
CONTACT RETENTION	0.9 kg (2 lbs)
DURABILITY	200 mating cycles min.
VIBRATION	20g's – no discontinuity > 1µs
SHOCK	100g's – no discontinuity > 1µs

MATERIAL AND FINISH	
SHELL	Aluminium Alloy 7075 nickel plated
MOLDED INSULATOR	PEEK
PIN CONTACTS	Gold Alloy
SOCKET CONTACTS	Gold Alloy
ENCAPSULANT	Epoxy Resin
PANEL SEAL	Silicone MVQ
PCB TRAY	PEEK or LCP
UNINSULATED	Gold plated solid copper alloy wire
HARDWARE	Stainless steel 300 series

## Recommended torque values

To secure the mating between plug and receptacle connector and Jam nut on the rear panel mount receptacle connector, please apply rear panel mount receptacle connector.

MATING TORQUE	JAM NUT ON REAR PANEL MOUNT
0.8 Nm	1 Nm

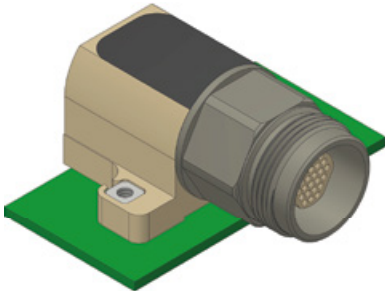

# CBR LAYOUT

## 15 SOCKET CONTACTS

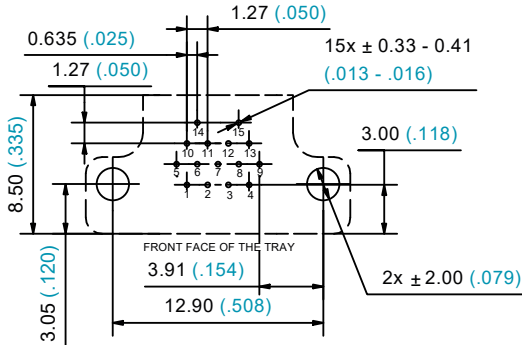

## 15 PIN CONTACTS

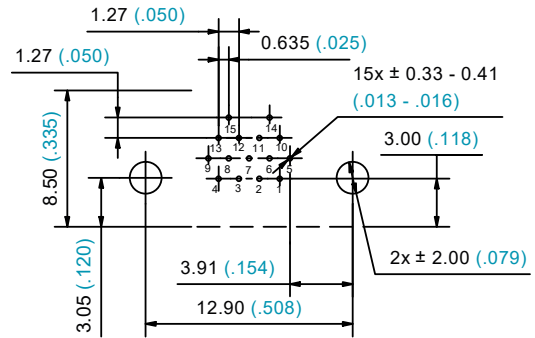

## 25 SOCKET CONTACTS

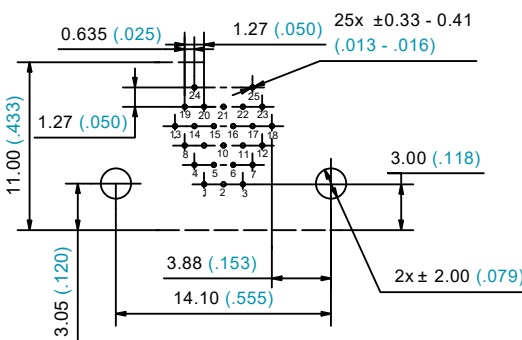

## 25 PIN CONTACTS

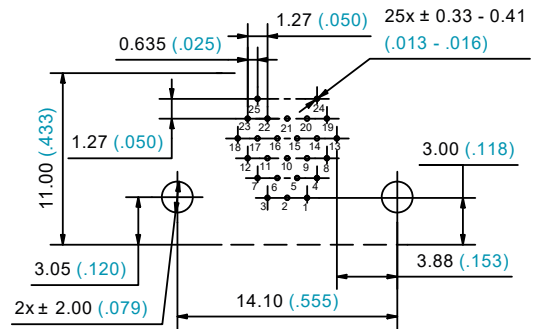

## 37 SOCKET CONTACTS

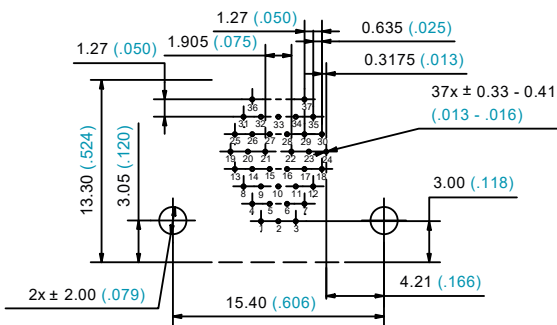

## 37 PIN CONTACTS

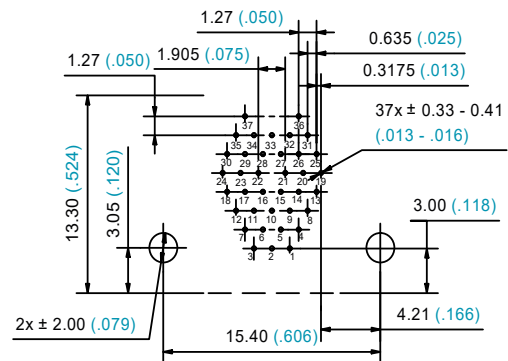

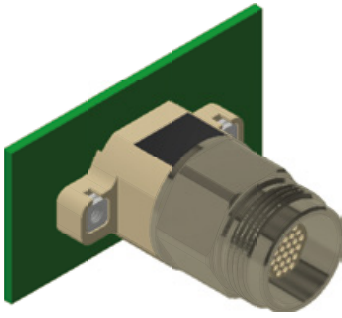

# BS LAYOUT

## 15 SOCKET CONTACTS

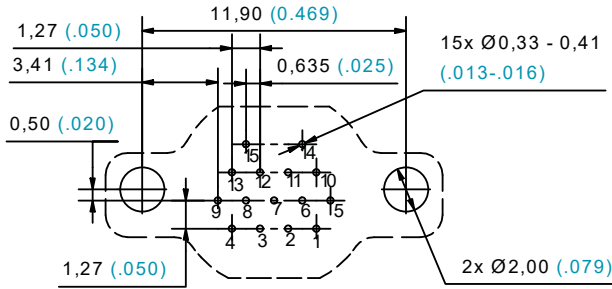

## 15 PIN CONTACTS

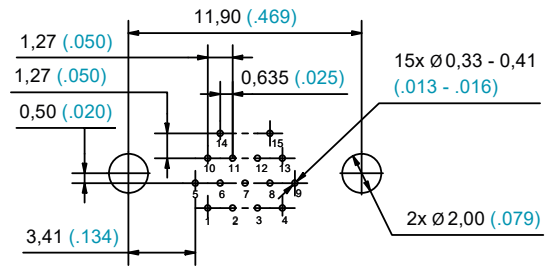

## 25 SOCKET CONTACTS

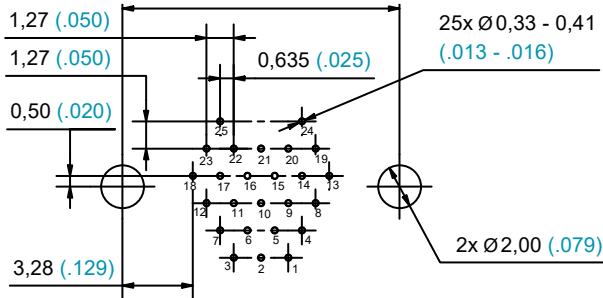

## 25 PIN CONTACTS

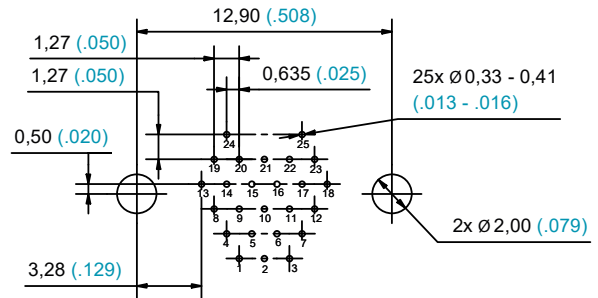

## 37 SOCKET CONTACTS

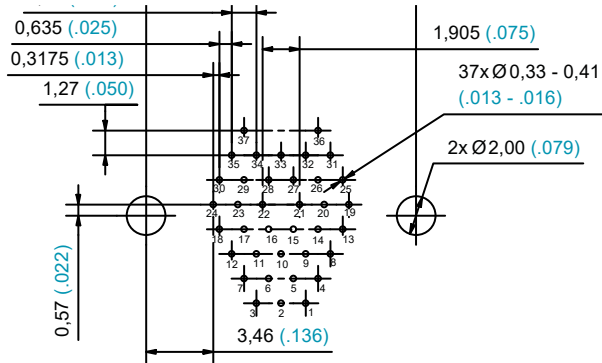

## 37 PIN CONTACTS

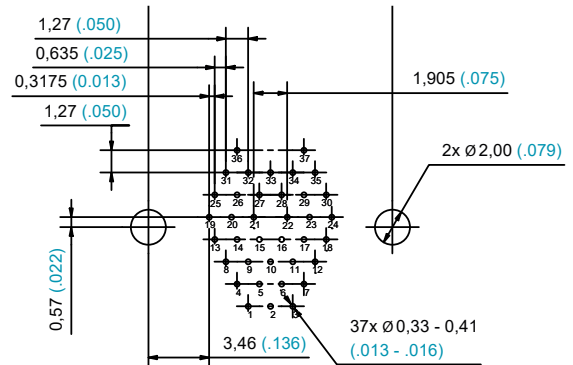



© 2023 AXON' CABLE – RELEASED DECEMBER 2024/B – ALL RIGHTS RESERVED  
Photos: Axon' Cable, Nickelkrome, Fred Laurès, Bastien Guilbert  
All information contained in this brochure can be changed without prior notice.

>> AUSTRALIA

AXON' CONNECT PTY LTD  
TEL.: +61 417 284 674  
sales.australia@axon-cable.com

>> BRAZIL

AXON' CABLE INDUSTRIA  
E. COMÉRCIO LTDA  
Tel.: +55 21 3596-8002  
salesbrazil@axon-cable.com

>> CANADA

AXON' CABLAGE INC/AXON' WIRING INC.  
Tel.: +1 514 898 2044  
sales@axoncable.com

>> CHINA

AXON' INTERCONNECT LTD  
Tel.: +86 757 2838 7200  
sales@axon-interconnect.com

>> GERMANY

AXON' KABEL GMBH  
Tel.: +49 7152-97992-0  
sales@axon-cable.de

>> HUNGARY

AXON' KÁBELGYÁRTÓ KFT.  
Tel.: +36 76 508 195  
axon@axon-cable.hu

>> INDIA

AXON' INTERCONNECTORS & WIRES PVT LTD  
Tel.: +91 (0) 806 816 2966  
sales@axon-cable.in

DHRUV: YOUR OFFSET PARTNER

DHRUV AXON' INTERCONNECT PRIVATE LTD

>> JAPAN

AXON' CABLE JAPAN OFFICE  
Tel.: +81 26 217 6728  
axon-japan@axon-cable.com

>> LATVIA

AXON' CABLE SIA  
Tel.: +371 6540 78 91  
axon@axoncable.lv

>> MEXICO

AXON' INTERCONEX,  
S.A. DE C.V.  
Tel.: +52 442 215 2713  
axon-mexico@axoncable.com.mx

>> SINGAPORE

AXON' CONNECT PTE LTD  
Tel.: +65 6250 3169  
sales.singapore@axon-cable.com

>> SPAIN

AXON' CABLE SPANISH OFFICE  
Tel.: +34 911 309 123  
axon-spain@axon-cable.com

>> UNITED KINGDOM

AXON' CABLE LTD  
Tel.: +44 1383 421500  
sales@axon-cable.co.uk

>> USA

AXON' CABLE INC.  
Tel.: +1 847 230 7800  
sales@axoncable.com

VISIT OUR WEBSITE  
[www.axon-cable.com](http://www.axon-cable.com)



FOLLOW US



6,10 ± 0,13  
(240 ± 0,05)

HEADQUARTERS  
>> France

>> AXON' CABLE S.A.S.

ROUTE DE CHALONS EN CHAMPAGNE - 51210 MONTMIRAIL  
TEL.: +33 3 26 81 70 00 - FAX: +33 3 26 81 28 83  
e-mail: sales@axon-cable.com - www.axon-cable.com

**axon'**  
cables & connectors

